



Jefferson House, 11 Basil Street,
Knightsbridge, SW3

Asking Price £680,000, Leasehold

NAPIER WATT

T: 0207 935 0011
E: enquiries@napierwatt.co.uk
W: napierwatt.co.uk

35 Berkeley Square, Mayfair, London, W1J 5BF







Description

Positioned only a stone's throw from Harrods and moments from Hyde Park is this immaculately presented studio apartment with 3m high ceilings throughout.

The apartment is located on the raised ground floor and benefits from large windows, giving plenty of natural light. The building benefits from a porter and lift, and offers easy access to Knightsbridge Under Ground Station (Piccadilly Line); it could make an ideal rental investment or pied à terre.

Jefferson House is located on the South Side of Basil Street, just moments from Harrods in the heart of Knightsbridge. It is within walking distance of all the area's world-famous shops, restaurants, hotels, and museums, and there are numerous local transport links nearby

· Studio Room · Bathroom · Kitchen · Air Conditioning, Lift · Porter · EPC Rating C

Key Features

- 3M CEILING HEIGHT
- PORTER
- AIR CONDITIONING
- 100M HARRODS

Terms

Leasehold : 1 September 2142 ie 116 years
 Service Charge 1 Jan 2026 to 30 Jun 2026 £2,061.22
 Council Tax : E

Jefferson House

Approx. Gross Internal Area 311 Sq Ft - 28.89 Sq M

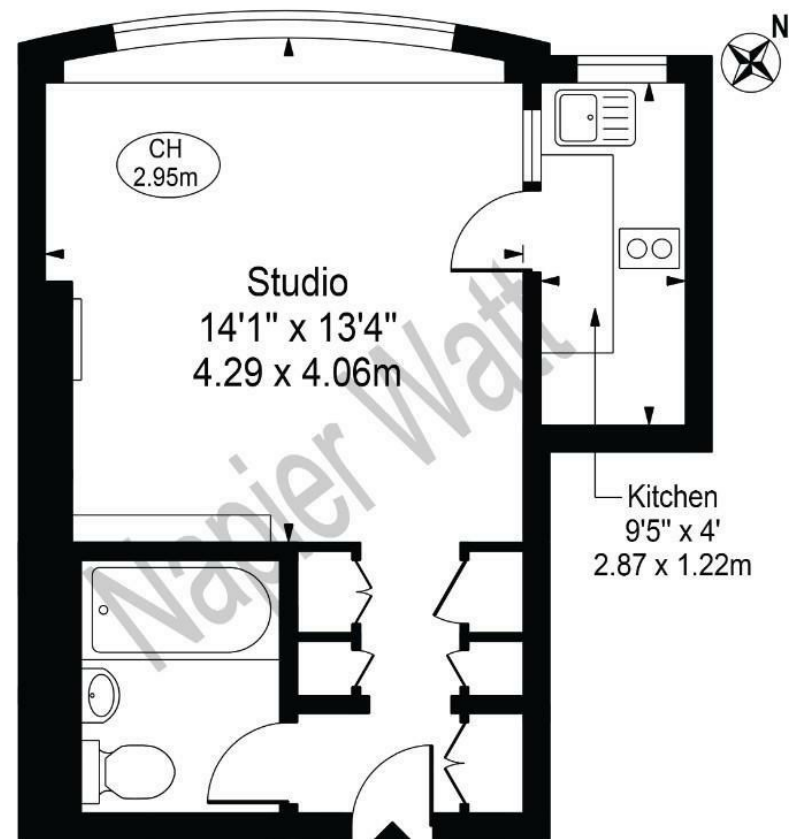

Raised Ground Floor

For Illustration Purposes Only - Not To Scale

This floor plan should be used as a general outline for guidance only and does not constitute in whole or in part an offer or contract. Any intending purchaser or lessee should satisfy themselves by inspection, searches, enquiries and full survey as to the correctness of each statement. Any areas, measurements or distances quoted are approximate and should not be used to value a property or be the basis of any sale or let.

IMPORTANT: We would inform prospective purchasers that these sales particulars have been prepared as a general guide only. A detailed survey has not been carried out, nor the services, appliances and fittings tested. Room sizes should not be relied upon for furnishing purposes and are approximate. If floor plans are included, they are for guidance only and illustration purposes only and may not be to scale. If there are any important matters likely to affect your decision to buy, please contact us before viewing the property.